

Anexa 21: Harta Sectia Chimica - spatii depozitare substante chimice si deseuri

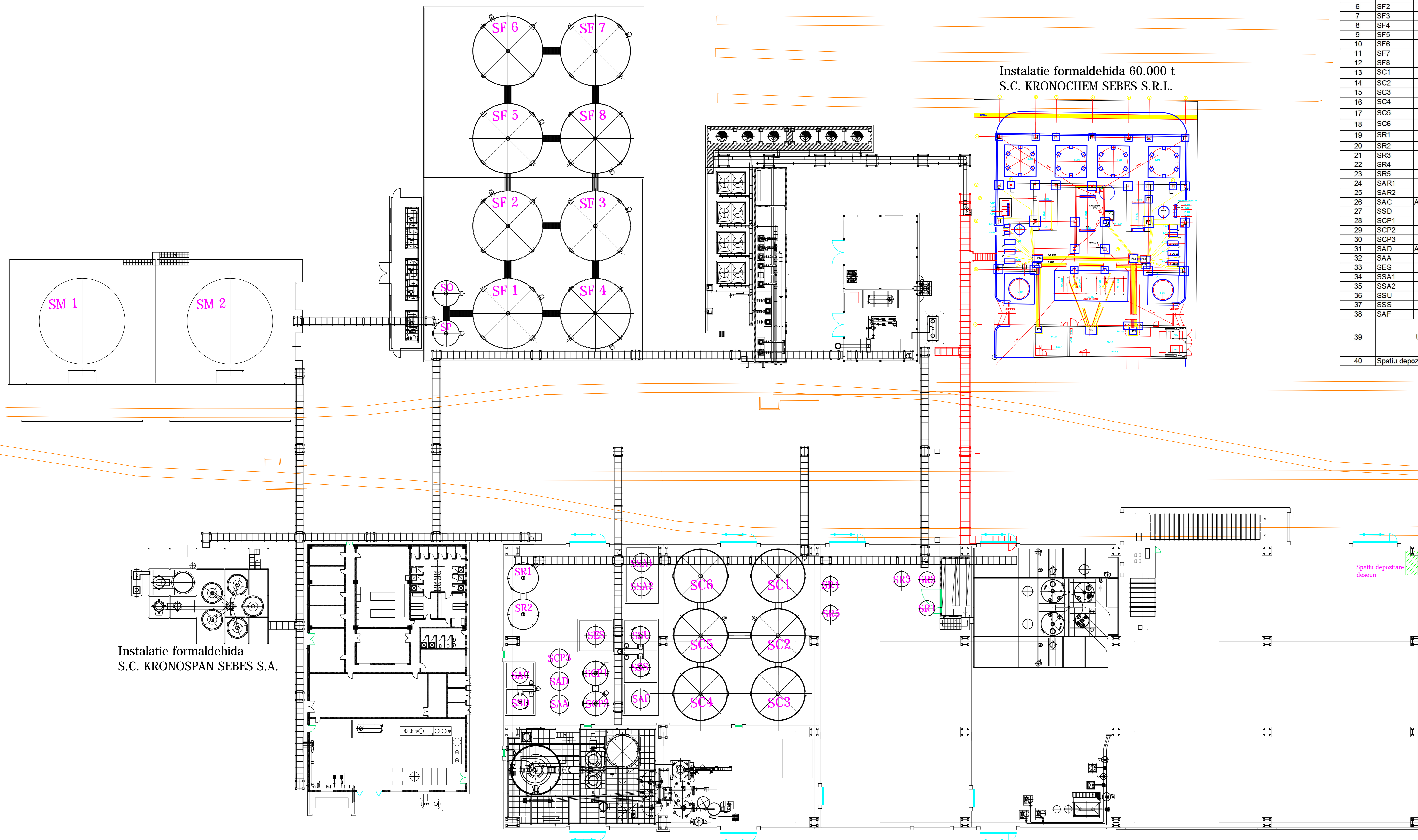

NR. CRT.	Cod identificare rezervor	Produs stocat/vehiculat	Coordonate STEREO 70	
			X(E) m	Y(N) m
1	SM1	Metanol	388237.392	497604.282
2	SM2	Metanol	388238.647	497629.245
3	SO	Formol	388234.412	497664.493
4	SP	Formol	388240.403	497664.192
5	SF1	Formol	388238.958	497675.276
6	SF2	Formol	388223.980	497676.028
7	SF3	Formol	388223.684	497690.057
8	SF4	Formol	388238.662	497689.305
9	SF5	Solutie UFC	388202.611	497669.094
10	SF6	Solutie UFC	388189.630	497669.746
11	SF7	Solutie UFC	388190.383	497684.724
12	SF8	Solutie UFC	388204.362	497684.021
13	SC1	Rasina lichida	388285.250	497719.997
14	SC2	Rasina lichida	388294.236	497719.545
15	SC3	Rasina lichida	388302.224	497719.144
16	SC4	Rasina lichida	388301.622	497707.162
17	SC5	Rasina lichida	388292.033	497695.632
18	SC6	Rasina lichida	388271.065	497696.685
19	SR1	Rasina lichida	388282.209	497739.169
20	SR2	Rasina lichida	388271.226	497739.721
21	SR3	Rasina lichida	388271.873	497732.681
22	SR4	Rasina lichida	388271.271	497720.699
23	SR5	Rasina lichida	388282.254	497720.147
24	SAR1	Apa recuperata	388280.844	497672.17
25	SAR2	Apa recuperata	388269.811	497671.723
26	SAC	Acid clorhidric 32%	388302.811	497671.066
27	SSD	Sol.soda 30%	388321.833	497671.111
28	SCP1	Rasina lichida	388303.413	497683.048
29	SCP2	Rasina lichida	388322.435	497683.093
30	SCP3	Rasina lichida	388292.079	497676.61
31	SAD	Apa demineralizata	388303.112	497677.057
32	SA	Apa dedurizata	388322.830	497676.103
33	SES	Intaritor	388292.430	497683.600
34	SSA1	Intaritor	388270.764	497690.695
35	SSA2	Intaritor	388281.747	497690.143
36	SSU	Sol. Uree	388292.781	497690.589
37	SSS	Sol.soda 30%	388302.766	497690.087
38	SAF	Acid formic 15%	388322.786	497690.082
			388292.861	497811.708
			388320.970	497813.298
39	UREE		388316.414	497762.475
			388290.453	497763.780
40	Spatiu depozitare deseuri		388274.989	497814.608

Instalatie formaldehida
S.C. KRONOSPAN SEBES S.A.

Instalatie formaldehida 60.000 t
S.C. KRONOCHEM SEBES S.R.L.

Spatiu depozitare deseuri

Kronospan
SEBES

KRONOSPAN SEBES SA
RO - 515800 - Sebes
M. Kogalniceanu Str. No. 59
Tel: +40 258 801 100
Fax: +40 258 801 199
E-mail: office.sebes@kronospan.ro

Date	03.09.2015	Scara	1
Proiectant	N. Căbu	Proiect	
Verificat	A. Anfal		

Kronospan Sebes

General Layout
Sectia Chimica Kronospan SEBES

Sheet No.	KSB 04 200 01	Revision	G	1/1
-----------	---------------	----------	---	-----

This drawing is Kronospan property and without our written approval it must not be copied, reproduced or be used available to third parties.